



## LED 2x2 TROFFER FIXTURE WITH EMERGENCY BATTERY BACKUP

Suspended Ceiling Grid Mount LED Downlight  
40watt, 120/277VAC<sub>in</sub>

### FEATURES & BENEFITS

This highly efficient LED Troffer with Emergency Battery Backup provides 90 minutes of high illumination levels at 20watts upon the loss of AC power, thereby reducing fixture counts and reducing electrical installation costs. Ideal for applications where suspended ceiling emergency lighting is required.

**ENERGY EFFICIENT** – This high lumen, low wattage product offers exceptional energy efficient value.

**MAINTENANCE FREE** – Eliminates costly bulb and/or ballast replacements, lens cleaning/replacements due to UV yellowing and is corrosion resistant. Reduces unnecessary landfill & disposal.

**ARCHITECTURALLY PLEASING DESIGN** – The Silescent 2x2 LED fixture looks outstanding in either the ON or OFF state.

**PLEASING LAMP COLOR** – Delivering pure (visible) light spectrum lighting originating from the highest quality COB array's producing the most vibrant of colors.

**WIDE AREA LIGHT DISTRIBUTION** – 140 degree distribution provides remarkable light coverage.

**INSTANT ON/OFF** – Designed for instant ON/OFF operation

**ENVIRONMENTALLY FRIENDLY** – No Hazardous Mercury Content.

**LISTINGS & COMPLIANCE** – UL1598 & UL924 listed Canada & US (ETL label), suitable for suspended ceiling-grid mount, RoHS compliant.

**DURABLE LIGHTWEIGHT CONSTRUCTION** – The smooth lines and construction of the Silescent 2x2 LED Troffer fixture weighs only **9 pounds** allowing for safe and easy installation.

**THERMAL MANAGEMENT** - Patented (No.'s: 7,810,960 & 8,360,614) HEAT FORWARD/LIGHT FORWARD proprietary technology using its thermal radiating trim which also provides mounting and style.

**EXTRA LONG LIFE** – 100,000 operating hours (@ 10 hrs/day is > 27 years)

**WARRANTY** – 5 year limited warranty, both LED and driver. Full warranty details available at [www.silescent.com](http://www.silescent.com)

**EASY MOUNTING/INSTALLATION** – *New Construction & Retrofit*: suitable for suspended ceiling grid mount.

**MADE IN USA** – Both driver and fixture are designed, engineered and mfr'd by Silescent Lighting in Ft. Lauderdale FL (ARRA & NAFTA compliant).



### ELECTRICAL DATA

- **Operating Temp:** -40°C to +40°C
- **Ambient Temp:** <35°C
- **Nominal Voltage:** 120/277VAC<sub>in</sub>
- **Operating Voltage:** 103 – 285VAC, 50 / 60 Hz

### PERFORMANCE SUMMARY

- **Lumens:** 3880 lumens (*delivered*)
- **Wattage:** 40 watts
- **Efficacy:** 97 lumens/watt
- **CCT:** 5000 Kelvin (>70CRI)

*See back of this document for emergency lighting performance data.*

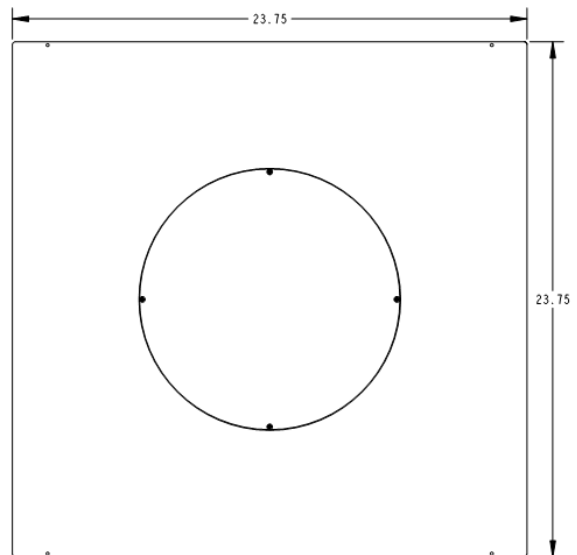
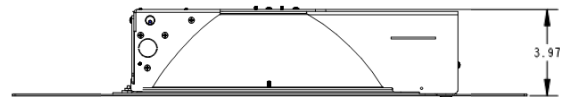

### SPECIFICATIONS

**THERMAL PLATE STYLE** – 24in x 24in, Square-Flat Thermal Plate.

**FINISH** – Standard Powder Coat White Finish.

**INPUT VOLTAGE** – 120/277VAC<sub>in</sub> (Silescent HN3 driver)

**LAMP TEMPERATURES (CCT)** – 5000 Kelvin (CRI>70)

**OPTIC** – Diffuser, 140 degree distribution.

**WATTAGE** – 40 watts.

**FIXTURE WEIGHT** – 9.0lbs

*Standard options available upon request (Finish & CCT). Pricing & lead-times may be affected. Contact Manufacturer.*



MADE IN USA

**TE2433HN40:** Diffuser, 120/277VAC<sub>in</sub>, 5000k, 65CRI, 39.1 Watts, 3796.2 Delivered Lumens, 97.0 Lm/W (measured)

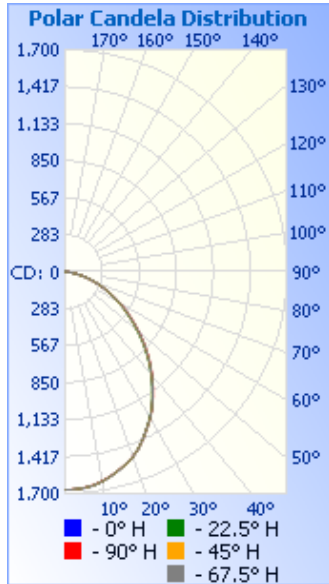

Lumens Per Zone			Zonal Lumen Summary		
Zone	Lumens	% Total	Zone	Lumens	% Luminaire
0-10	158.2	4.2%	0-30	1,254.8	33.1%
10-20	445.9	11.7%	0-40	1,986.6	52.3%
20-30	650.7	17.1%	0-60	3,218.3	84.8%
30-40	731.8	19.3%	60-90	577.8	15.2%
40-50	685.5	18.1%	70-100	212.7	5.6%
50-60	546.2	14.4%	90-120	0	0%
60-70	365.1	9.6%	0-90	3,796.2	100%
70-80	178.4	4.7%	90-180	0.0	0%
80-90	34.4	0.9%	0-180	3,796.2	100%

	Illuminance at a Distance		
	Center Beam fc	Beam Width	
2.0ft	419.5 fc	4.2 ft	4.3 ft
4.0ft	104.9 fc	8.5 ft	8.6 ft
6.0ft	46.6 fc	12.7 ft	12.9 ft
8.0ft	26.2 fc	17.0 ft	17.2 ft
10.0ft	16.8 fc	21.2 ft	21.4 ft

■ Vert. Spread: 93.5°    ■ Horiz. Spread: 94.0°

.ies files available upon request  
(contact manufacturer; TR108-T2\*)

**EMERGENCY LIGHTING FEATURES & BENEFITS**

**EMERGENCY LIGHT OPERATION** – This unit also operates as emergency fixture. In the event of a power failure, the emergency battery ballast will illuminate for required 90 minutes and at 20watts.

**ELECTRICAL RELIABILITY:**

- Current-limiting charger prolongs battery life and minimizes energy consumption.
- Battery: maintenance free 5000-milliAmp-hour (mAh) Nickel-Metal Hydride battery provides 20 watts capacity for 90 minutes.
- Test switch and dual function ready/charge light (red) permit check of system operation (push to test).
- Low-Voltage disconnect prevents excessively deep discharge that can permanently damage the battery.
- Battery is easily replaceable.

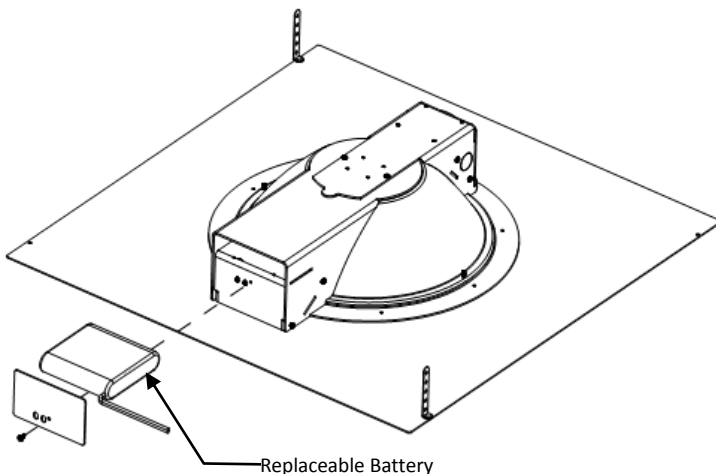

**ELECTRICAL DATA (CHARGING)**

- **Operating Temp:** -40°C to +40°C
- **Ambient Temp:** <35°C
- **Nominal Voltage:** 120/277 VAC<sub>in</sub>
- **Operating Voltage:** 103 – 285VAC, 50 / 60 Hz
- **Leading Reactive:** 64 VAR
- **Breaker Power:** 65 VA
- **Nominal Current:** .25 Amps (RMS)

**LIGHTING PERFORMANCE (DIS-CHARGING)**

- **Lumens:** 1800 lumens (delivered)
- **Watts:** 20 watts
- **Efficacy:** 81 lumens/watt
- **CCT:** 5000 Kelvin (65CRI)
- **Duration:** >90 minutes
- **Charge Time:** 22 hours
- **Test Switch:** Press to test (momentary)

Catalog #:	TE2433HN40	Type
Project:		
Comments:		Date
Prepared by:		